

Many of your neighbours have already expressed their concerns in writing about these early stage proposals to our local councillors and have requested their support. We would urge you to do the same as soon as possible before valuable council resources are spent bringing this development to the point of a formal planning application.

Paul Upex Cllr_Paul.Upex@lewisham.gov.uk

Maja Hilton Cllr_Maja.Hilton@lewisham.gov.uk

Peter Bernards Cllr_Peter.Bernards@lewisham.gov.uk

Please also consider visiting them at their bi-weekly surgery on a Saturday (details via the LB website <http://councilmeetings.lewisham.gov.uk/>)

Eliot Bank Initial Proposal

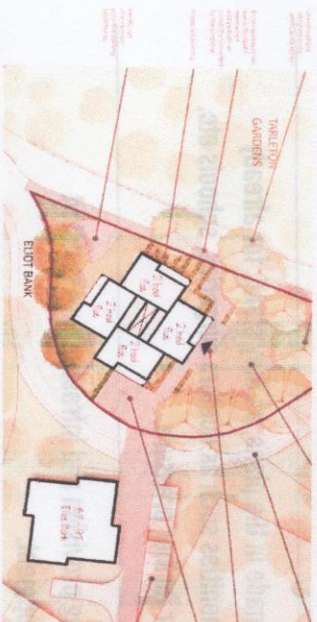

FURTHER INFORMATION AVAILABLE AT:

<https://www.dropbox.com/sh/d7btw07eswmsqWZ/AABDKD3vXKzZmHtVpZzBKua?dl=0>

Prepared by the
Tarlton Woods
Residents Association

OTHER USEFUL CONTACTS TO REGISTER YOUR CONCERNS WITH:

Mayor

Sir Steve Bullock
steve.bullock@lewisham.gov.uk

**Cabinet Member
for Housing**

Mr Damien Egan
damieng.egan@lewisham.gov.uk

**Chair of Housing
Select Committee**

Mr Carl Handley
citr_carl.handley@lewisham.gov.uk

ELIOT BANK TOWER BLOCK PROPOSAL

Did you know that Lewisham Council are proposing a new private development in close proximity to your house consisting of a tower possibly 7, 12 or 15 storeys high?



The proposed development covers grassland on the Forest Estate (Eliot Bank) as well as public housing on garages and car park off Knapdale close. This is in addition to the already granted planning permission for a large development (41 flats and houses) at Featherstone Lodge, Eliot Bank.



VIEW FROM BOTTOM OF ELIOT BANK - BEFORE AND AFTER

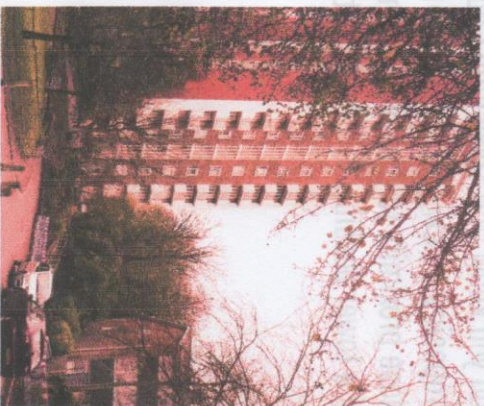

VIEW FROM BOTTOM OF SYDENHAM RISE - BEFORE AND AFTER



While most people understand the need for building genuinely affordable homes in the London boroughs, we believe that this particular scheme is ill thought out and giving over another piece of public land to private ownership.

There are many reasons to oppose this development, which is currently in the outline proposal stage. Here are a few:

Although it is in the early stages, there has been no discussion nor acknowledgement of the need to consult with residents on the Dulwich Estate of the developments that will affect us.

There is no provision made in the plans, as they stand, for already much needed local amenities such as doctors surgeries, schools etc. which will be put under further pressure.

The local road / parking provision and infrastructure is not fit for such a large development.

Many existing homes and our amenity areas will be adversely affected and will be overshadowed / overlooked.

The (100% private) tower will be built on a piece of publicly owned green space that we will never get back.
