



Design and photography: The Dzine Partnership 020 8314 1692



PRENDERGAST  
PRIMARY SCHOOL



*'Children have a wide range of activities and resources to support the development of their knowledge and skills in all areas of learning.'*

*'There is a calm and happy atmosphere around the Reception classrooms.'*

Ofsted September 2014

**Be part of our journey to outstanding education.**



Prendergast Primary School  
Manwood Road  
London SE4 1SA  
020 8690 1114  
admin@ladywellfieldscollege.lewisham.sch.uk  
www.prendergast-ladywell.com

**A Family School  
at the Heart of the Community**



Prendergast Primary School is a new local school which opened to two Reception classes in September 2014. Our school is part of the Leathersellers' Federation and has a strong ethos of developing every child to reach their full potential by providing a stimulating learning environment and innovative and engaging teaching methods.

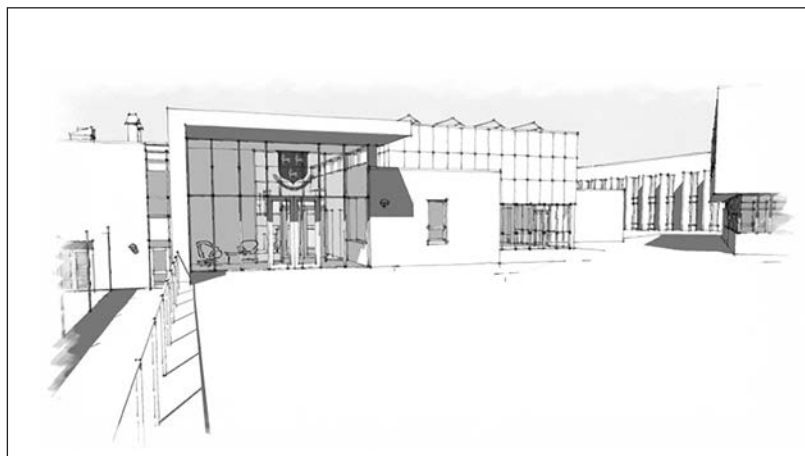

We will grow to a full two-form entry primary school by 2020 and will be situated in a purpose built, state of the art building next to Ladywell Fields.

#### What will my child do in Reception?

We believe in supporting and guiding each individual child's development to their full potential therefore our reception classes promote the characteristics of effective learning which are:

##### Playing and exploring - engagement

- Finding out and exploring
- Playing with what they know
- Being willing to 'have a go'

##### Active Learning - motivation

- Being involved and concentrating
- Keeping trying
- Enjoying achieving what they set out to do

##### Creating and thinking critically - thinking

- Having their own ideas
- Making links
- Choosing ways to do things

